

SHEET No 1
 PLAN No 1555
WATERMAN AVENUE SEWER
 BETWEEN
**RIALTO AVENUE AND A POINT 155' SOUTH
 OF THE SOUTH LINE OF RIALTO AVENUE**
 IN THE
 CITY OF SAN BERNARDINO
 CALIFORNIA

AUGUST 7, 1949

R. D. FORSYTHE
 Acting City Engineer

PLAN ADOPTED October 5, 1949

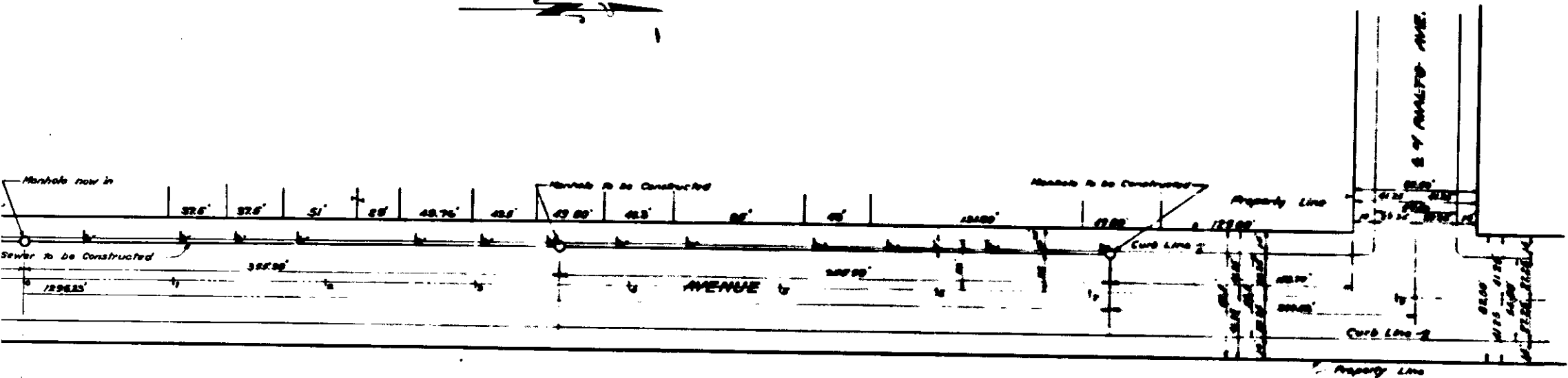

PLAN
 Scale 1"=40'



LEGEND

- 10" means man or holes
- 10" means feet or feet
- N# means number
- CL means Center Line
- EL means Elevation
- 8" W.P. means 8" Wrought Pipe Sewer to be constructed shown thus: ————
- 8" C.W. means 8" Cast Iron Sewer to be constructed shown thus: ————
- Manhole to be constructed shown thus: —○—
- Manhole now in shown thus: —○—
- 8" W.P. Pipe Sewer now in, shown thus: ————
- St means Street
- Av means Avenue
- Blvd means Boulevard
- CaW means California

SEWER DETAIL

- Lineal Ft of 8" Wrought Pipe Sewer to be constructed: 156.88'
- Lineal Ft of 8" Cast Iron Sewer to be constructed: 151.00'
- N# of 8" W.P. Wyes with 4" Connecting Sewers to be constructed: 83
- N# of Manholes to be constructed: 4

TITLE TO STREETS

WATERMAN AVENUE, indicated by Map of San Bernardino County, California, recorded in Book 7 of Maps at Page 2, Records of San Bernardino County, California.

GRADE ORDINANCE

Grade of WATERMAN AVENUE was established by Resolution No 1706 of the City of San Bernardino, California.

DATUM

All elevations shown in Red ink are in feet and are above a plane which is 1043.25 feet below the City Bench Mark as established by Ordinance 583 of the City of San Bernardino, California.

NOTE
 All 8" W.P. Connecting Sewers shall be constructed on an upward grade of feet per cent from the Main Sewer and shall terminate from the Main Sewer to a point 51' from Center Line of Street.

PROFILE LEGEND
 Approximate Present Surface of Ground, shown by Black Line thus: ————
 Flow Line of Sewer to be Constructed, shown by Red Line thus: ————

